

## SHURFLO® OIL CHANGE SYSTEM

### INSTALLATION & OPERATION INSTRUCTIONS

MODEL 8050-426



#### FEATURES

<b>Suitable for Pumping:</b>	Engine oil, automatic transmission fluids, anti-freeze solutions and low viscosity gear lubes
<b>Dry Run Capabilities:</b>	Yes
<b>Pump Body:</b>	Polypropylene
<b>Diaphragm:</b>	Geolast, oil resistant
<b>Valves:</b>	Buna-n
<b>Motor:</b>	12V DC with internal thermal protector
<b>Receiver:</b>	Plastic with 3 Gallon [11.4 Liter]
<b>Battery Leads:</b>	8 feet [ 2.4m ] with alligator clips
<b>Suction Tube:</b>	8 feet [ 2.4m ], 1/4" OD, oil and heat resistant
<b>Dimensions:</b>	15 1/2" [ 393mm ] high
<b>Weight:</b>	6.4 lb [ 2.9kg ]

#### WARNING

**Explosions hazard. DO NOT PUMP GASOLINE OR DIESEL FUEL.** Take necessary precautions to rid area around battery of potential explosive gases. Run your bilge blower motor for additional protection. Continue ventilation during oil changing procedure. Failure to do so can result in explosion. Injury or death can occur.

**Explosions hazard. Motor switch MUST be in "OFF" position when connection and disconnecting alligator clips to battery terminals and ground. the switch in an "ON" position can cause electrical spark which can result in explosion. Injury or death can occur.**

#### OPERATION INSTRUCTIONS

1. Vent bilge area. Run the engine for 5 to 10 minutes to heat up and thin oil. Oil should be 140°F-160° F [60°-71°C]. Turn off engine prior to removing oil.
2. Remove dipstick and insert the oil probe tube making certain it is at the bottom of the oil pan. It may help to measure the probe against the dipstick, add an inch and mark the probe.
3. Check that pump switch is in OFF position. Connect red (+) clip to battery (+) terminal. Connect black (-) clip to (-) ground terminal.
4. Energize the pump by turning switch, located on the motor rear end-bell to the "ON" position. Turn off pump when oil removal is completed. It will be easy to detect through the clear tube. Do not worry about running pump dry, pump has run dry capabilities.
5. Remove probe from dipstick tube while wiping with a rag to prevent oil spills.
6. To empty the container, pull up the retractable pour spout and pour the oil.
7. Please recycle or dispose of used oil and fluid in a responsible manner that is friendly to our environment. Please check the laws of your state and follow all USCG regulations.
8. To store, wrap tubing around pump loosely and insert oil probe tube into the small hole in the lid.

**NOTE:** This pump is suitable for engine oil, automatic transmission fluids, anti-freeze solutions, and low viscosity gear lubes.

## NOTES

MAKE SURE LID IS SECURELY FASTENED TO BUCKET BEFORE TRANSFERRING LIQUID.

### TO SECURE LID TO BUCKET:

LUBRICATE THE SEALING LIP OF THE BUCKET AND LID. START A SECTION OF THE LID SEAL TO THE BUCKET BY KNEELING ON IT. USE A Mallet TO SNAP THE LID TO THE BUCKET WHILE KNEELING ON IT MAINTAIN THE SNAP. STARTING NEXT TO YOUR KNEE WORK AROUND THE LID UNTIL FULLY SEATED/ SEALED.

- ALWAYS VENT BILGE AREA
- OIL MUST BE 140-160°F [60-71°C]
- SOLIDS/PARTICULATES IN THE FLUID MAY DAMAGE PUMP
- PUMP PORTS ARE 3/8" F-NPT
- FLOW RATE DEPENDS UPON OIL/ FLUID VISCOSITY & TEMPERATURE

## CAUTION

Oil may be **HOT** when performing oil change procedure use adequate eye protection gloves and clothing.

Pump is equipped with an automatic thermal breaker. In the event of overload or high temperature, the circuit will "open". Once the motor temperature is within proper limits, it will automatically reset and the pump will start operation without warning.

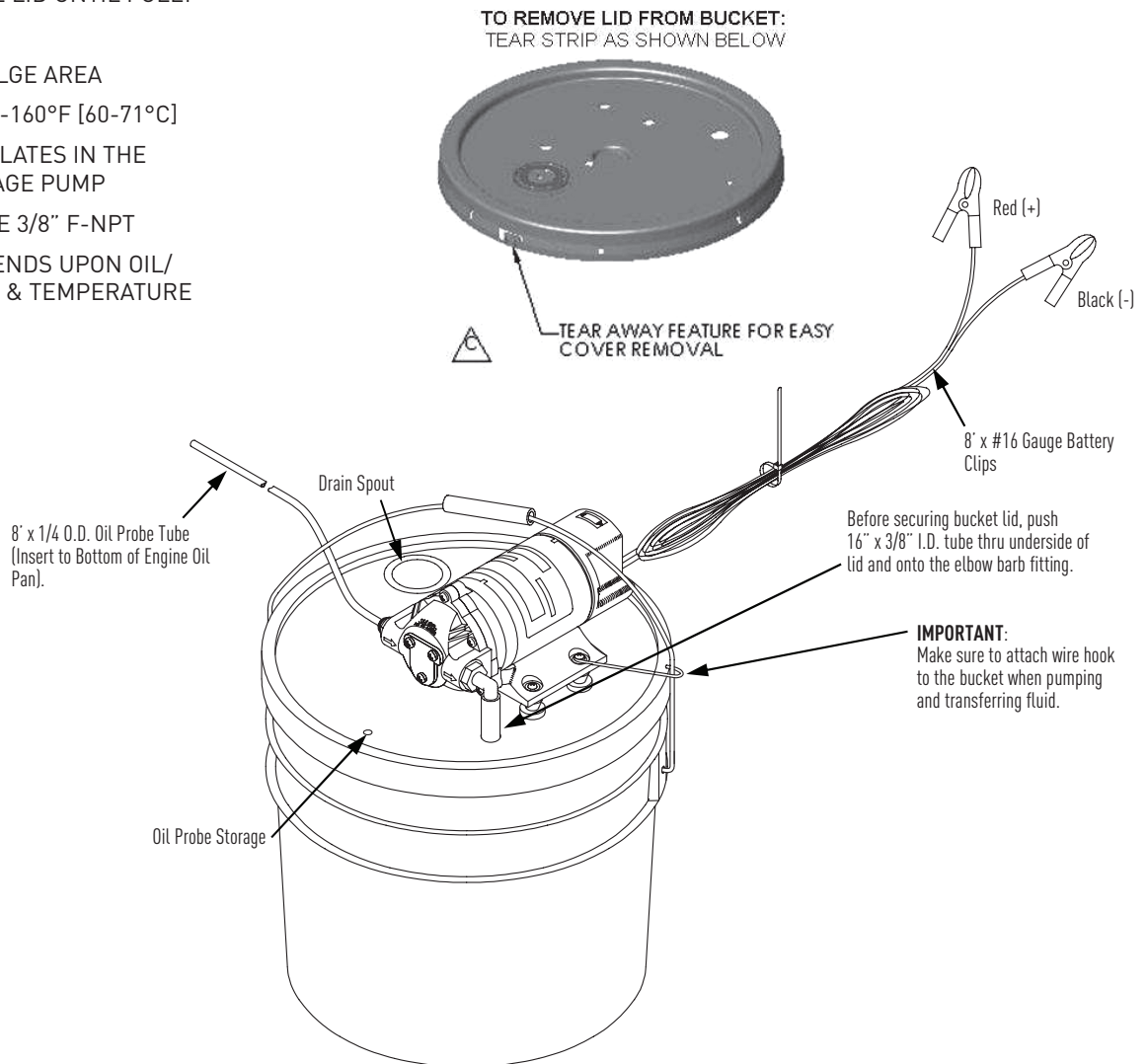

### WATER PURIFICATION

3545 HARBOR GATEWAY SOUTH, SUITE 103, COSTA MESA, CA 92626, (800) 854-3218 WWW.SHURFLO.COM

All Pentair trademarks and logos are owned by Pentair, Inc. All other brand or product names are trademarks or registered marks of their respective owners. Because we are continuously improving our products and services, Pentair reserves the right to change specifications without prior notice. Pentair is an equal opportunity employer.